

## Thickness Gauges

with stand

► Range of 50 mm and with lifting device

Technical data:

| Model ( analogue )                           | K 300/50   | J 300/50   |
|--|--|--|
| Reading                                      | 0,1 mm   | 0,01 mm  |
| Range  | 50 mm  | 50 mm  |
| Range per revolution                         | 10 mm  | 1 mm   |
| Bezel- $\varnothing$                         | 58 mm  | 58 mm  |
| Depth of jaw                                 | 300 mm   | 300 mm   |
| Accuracy according to manufacturing standard | 0.0500.9.0004<br>hysteresis fu however not checked | 1.0200.9.0002<br>hysteresis fu however not checked |
| Standard contact point                       | form c   | form c   |
| Optional contact point                       | form a, b, d or e                                  | form a, b, d or e                                  |

| Model ( digital )      | JD 300/50                                       | FD 300/50                                      |
|------------------------|---|--|
| Resolution             | 0,01 mm   | 0,001 mm                                       |
| Range                  | 50 mm   | 50 mm  |
| Depth of jaw           | 300 mm  | 300 mm   |
| Accuracy according to  | 30 $\mu$ m<br>hysteresis fu however not checked | 7 $\mu$ m<br>hysteresis fu however not checked |
| Output                 | RS 232 or USB                                   |  |
| Standard contact point | form c  | form c   |
| Optional contact point | form a, b, d or e                               | form a, b, d or e                              |

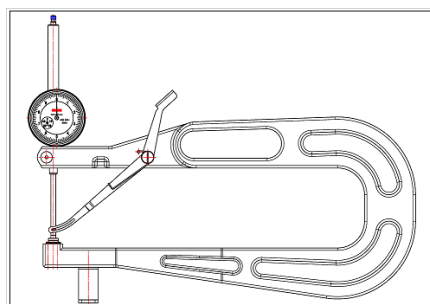

K 300/50

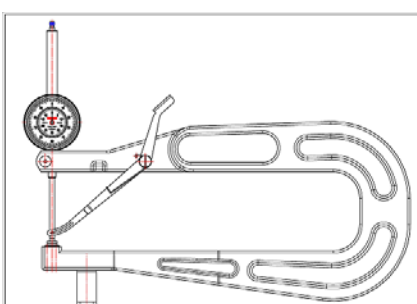

J 300/50

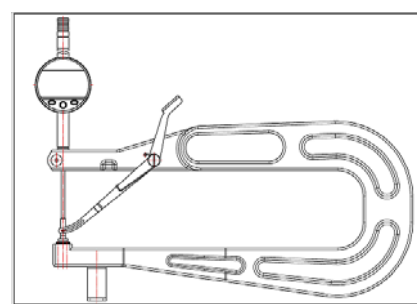

JD 300/50 and FD 300/50

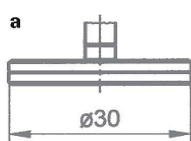

rubber,  
felt,  
soft materials

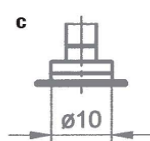
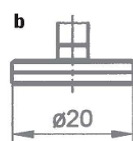

soft leather,  
cardboard,  
paper, foils

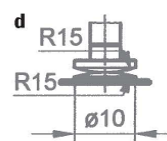

hard leather,  
plywood,  
fibrous  
plates



sheets,  
hard materials